

Product features

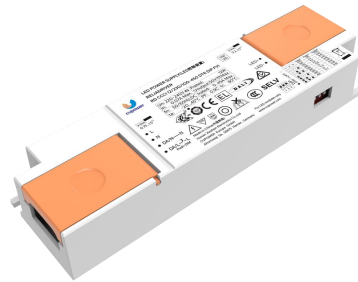

- Isolated adjustable power LED driver
- Support DALI-2, Push Dimming
- Output current 350-700 mA by DIP Switch adjust
- Current output default value 100%
- Max. output power 20 W
- For luminaries of protection class I, II
- 5-year warranty
- DC emergency
- Constant lumen output(CLO)



Product specifications

160853 RD CCCI 12/230/100-450 DT6 DIP FV1

Output current	Input voltage	Output voltage	Efficiency @full	Current accuracy	Power factor	Dimension LxWxH (mm)
100 mA, 150 mA 200 mA, 250 mA 300 mA, 350 mA 400 mA, 450 mA	220...240 Vac 220...240 Vdc	9...42 Vdc	82.5%	± 5%	0.9 (Output power >6.5W @ 230 Vac 50 Hz)	133x38x21

Electrical specifications

Mains voltage supply

Rated input voltage range	220...240 Vac
Max. input voltage range	198...264 Vac
Rated frequency range	0/50/60 Hz
Max. input current	0.07 A @ 230 Vac

Battery operation

DC voltage range	220...240 Vdc
Max. DC voltage range	176...276 Vdc

Protection against voltage peaks

Withstand voltage	I/P-O/P: 3.75 kVac, < 5 mA 60 sec, I/P-DA: 1.5 kVac, <5mA 60 sec; O/P-DA: 1.5 vKac , <5 mA 60 sec
Mains surge immunity	L-N 1KV

Total harmonic distortion (THD)

At rated input voltage range @ full load	10%
--	-----

Output data

Output current tolerance	±5% at rated input voltage range
No load output voltage	50 Vdc
Ripple output current	5%(ripple = peak/average total 100 Hz)
Output PstLM	1% at full load @ rated input voltage
Output SVM	0.4% at full load @ rated input voltage

Protection functions output side

Overvoltage protection	The output voltage is less than or equal to 50 V
Overpower protection	The output power is less than or equal to 14 W

Dimming operation and interface

Standby power consumption	≤ 0.5W
---------------------------	--------

Connection terminals

Connection terminal type	45° push in terminal
Wire cross section	Input wire: 0.75 - 1.5 mm ² ; Output wire: 0.2-1.5mm ²
Wire stripping length	8-9mm

Degree of protection

Protection rating	IP20
-------------------	------

Operating data

Output current range	DIP control adjusts the current: 100...450 mA
Default current	100 mA
Output voltage range	9...42 Vdc

Circuit breaker / Inrush current

	Inrush current I _{peak} : 4.15 A			Inrush current T _{width} : 36 μs	
MCB loading quantity	MCB type	B10	C10	B16	C16
	Units	131	131	210	210

Supplementary instructions

- The luminaire manufacturer is responsible for measuring and verifying the EMI compliance of the complete luminaire, as the level of radio interference will vary depending on the luminaire construction. Especially primary and secondary cable lengths and their routing may have a significant effect on radio interference.
- For the push DIM function, please follow our instructions, which can be downloaded from www.cupower.com.

Environmental specifications

Operating temperature	-20... +45°C
Storage temperature	-25...85°C
Working humidity	10%...90%
Store humidity	5%...95%
Lifetime	at Tc 80°C: 50,000 hrs @ 230 Vac
Maximum Tc temperature	80°C

Safety & EMC compliance

ENEC+CE	CCC	SAA
EN 61347-1:2015/A1: 2021	GB 17625.1-2022	AS/ 61347.2.13:2018
EN 61347-2-13:2014/A1: 2017	GB/T 17743-2021	AS/NZS 61347.1:2016+ A1 Lamp Control Gear- Part 2-13
EN IEC 62384: 2020	GB 19510.1-2009	
EN IEC 55015: 2019/A11: 2020	GB 19510.14-2009	
EN IEC 61547: 2023		
EN IEC 61000-3-2:2019/A1: 2021		
EN 61000-3-3: 2013/A2: 2021		
EN62493:2015/A1: 2022		

Dimensions

Housing dimensions

Length (L)	133 mm
Width (W)	38 mm
Height (H)	21 mm
Weight	0.069kg

Packaging details

Packing units	86 pcs.
Carton size	352 x 276 x 138 mm
Weight	6.1kg

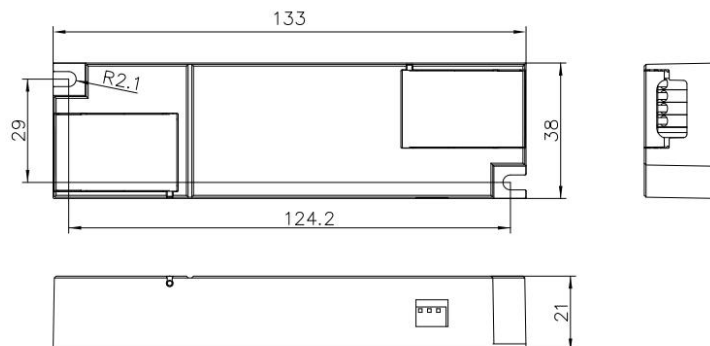

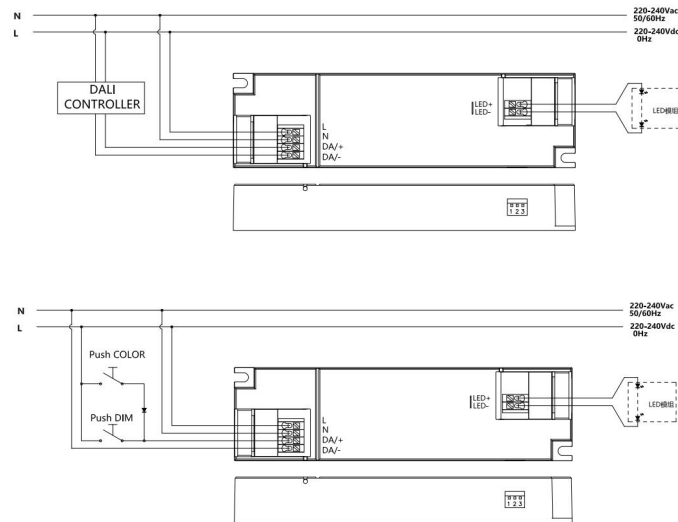

- All connections must be as short as possible to ensure good EMI performance.
- The luminaire wire should keep a certain distance from the LED power supply and other wires (5 - 10 cm is preferred).
- No secondary switches are allowed.
- Incorrect wiring can damage the LED.
- The wire must be well protected against short circuits.

Technical information

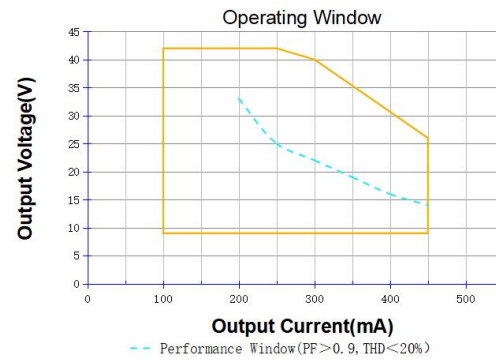
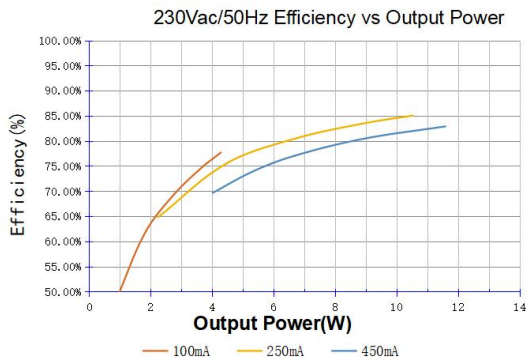
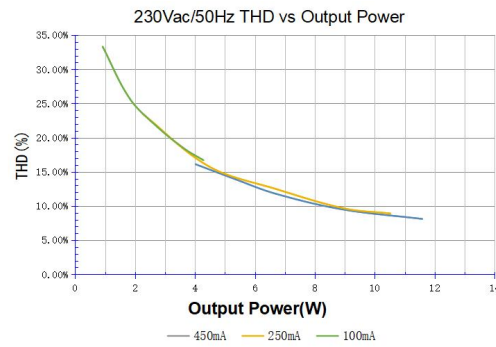
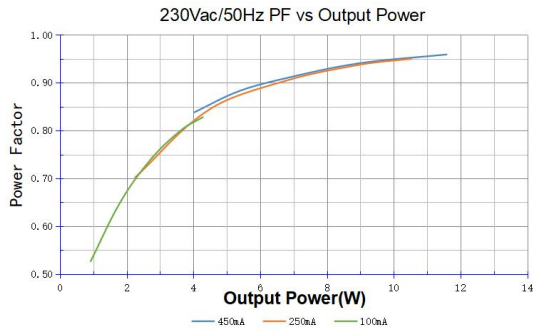

Vout	Pout	Iout	1	2	3
9-42 Vdc	4.2 W	100 mA	-	-	-
9-42 Vdc	6.3 W	150 mA	-	-	ON
9-42 Vdc	8.4 W	200 mA	-	ON	-
9-42 Vdc	10.5 W	250 mA	-	ON	ON
9-40 Vdc	12 W	300 mA	ON	-	-
9-34 Vdc	11.9 W	350 mA	ON	-	ON
9-30 Vdc	12 W	400 mA	ON	ON	-
9-26 Vdc	11.7 W	450 mA	ON	ON	ON